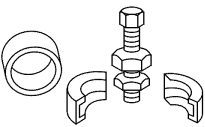
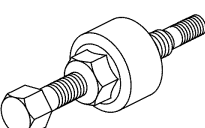

REMOVAL AND INSTALLATION

Power Steering Pump Pulley — 4.6L, 5.4L

Special Tool(s)

 ST1290-A	Remover, Power Steering Pump Pulley 211-016 (T69L-10300-B)
 ST1586-A	Installer, Power Steering Pump Pulley 211-185 (T91P-3A733-A)

4.6L Engine

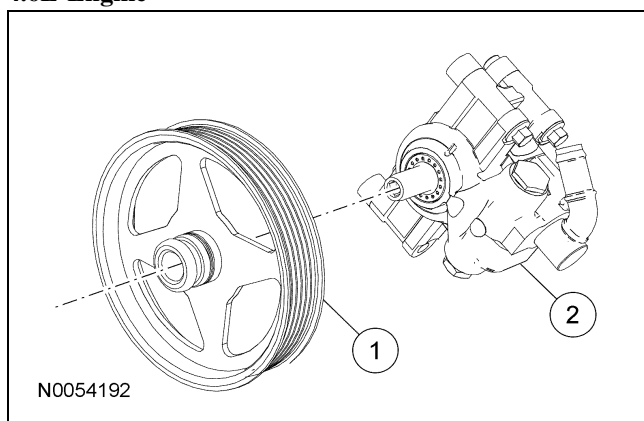

Item	Part Number	Description
1	3A733	Power steering pump pulley
2	3A674	Power steering pump

5.4L Engine

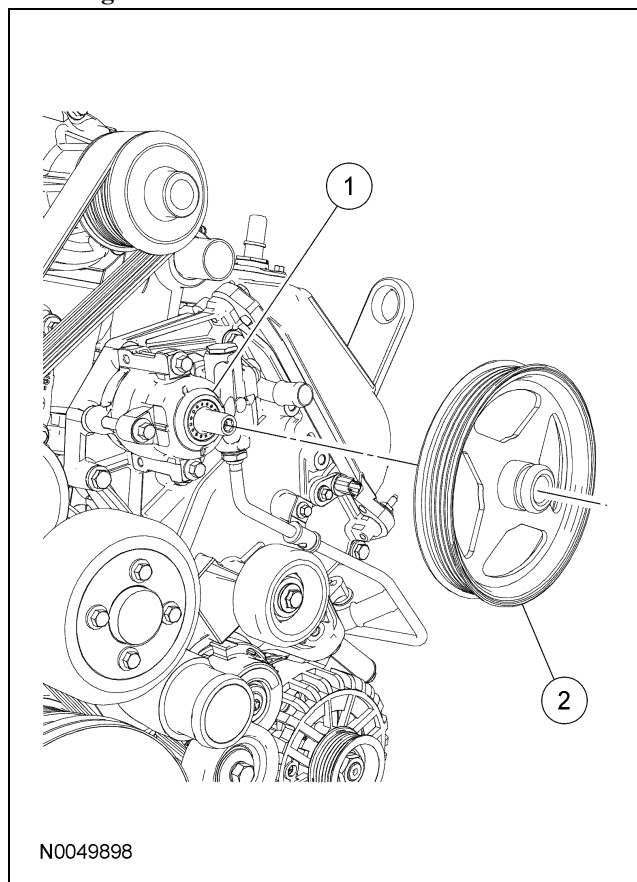

Item	Part Number	Description
1	3A674	Power steering pump
2	3A733	Power steering pump pulley

Removal

4.6L engine

1. Remove the air cleaner outlet pipe. For additional information, refer to Section 303-12.

4.6L and 5.4L engines

2. Rotate the tensioner and remove the accessory drive belt from the power steering pump pulley.

REMOVAL AND INSTALLATION (Continued)

3. Using the special tool, remove the pulley.

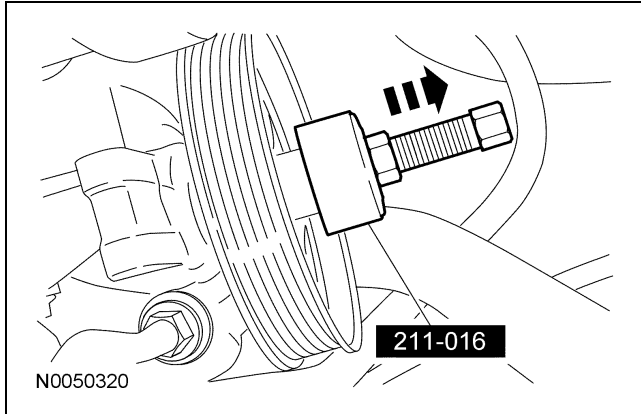
**Installation****4.6L and 5.4L engines**

1.  **CAUTION:** If the pulley has been removed and installed twice, install a new power steering pump pulley.

Using the special tool, install the pulley.

- Inspect the pulley for paint marks in the web area near the hub. If there are 2 paint marks, install a new pulley. If there is no paint or one paint mark, use a paint pencil to mark the web area of the pulley near the hub.

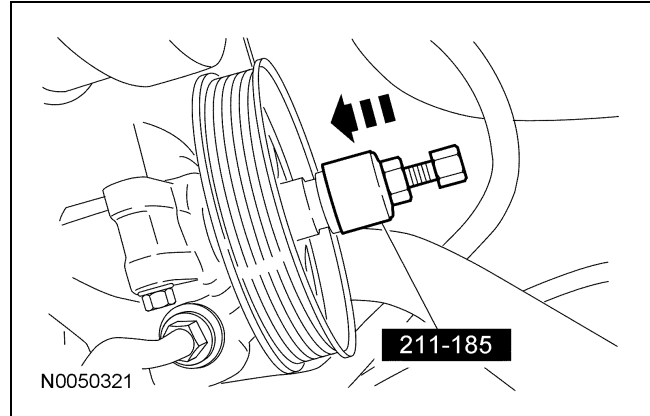

2. Rotate the tensioner and install the accessory drive belt to the power steering pump pulley. For additional information on the accessory drive belt routing, refer to Section 303-05.

4.6L engine

3. Install the air cleaner outlet pipe. For additional information, refer to Section 303-12.